

Ibstock Sales Office:  
**0870 903 4008**

Technical Service Helpline:  
**0870 903 4017**

Design Advice Helpline:  
**0870 903 4018**

Samples & Literature  
Hotline:  
**0870 903 4030**

For fast and easy access to the comprehensive  
range of Ibstock products and services visit  
**www.ibstock.com**

**Ibstock Brick Limited**  
United Kingdom  
Leicester Road, Ibstock,  
Leicestershire LE67 6HS  
t: 01530 261999 f: 01530 257457  
e: marketing@ibstock.co.uk

April 2006  
The information contained within this publication is as accurate as possible at the time of going to  
press. However, this document does not form part of any contract and Ibstock cannot accept liability  
for any errors or omissions. In order to maintain its position as a market leader, Ibstock operates  
a policy of continuous product development and therefore reserves the right to alter specifications  
without notice.

© Ibstock Brick Limited 2006

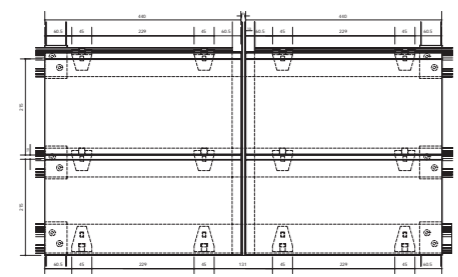

General Assembly Front Elevation  
(Not to scale)

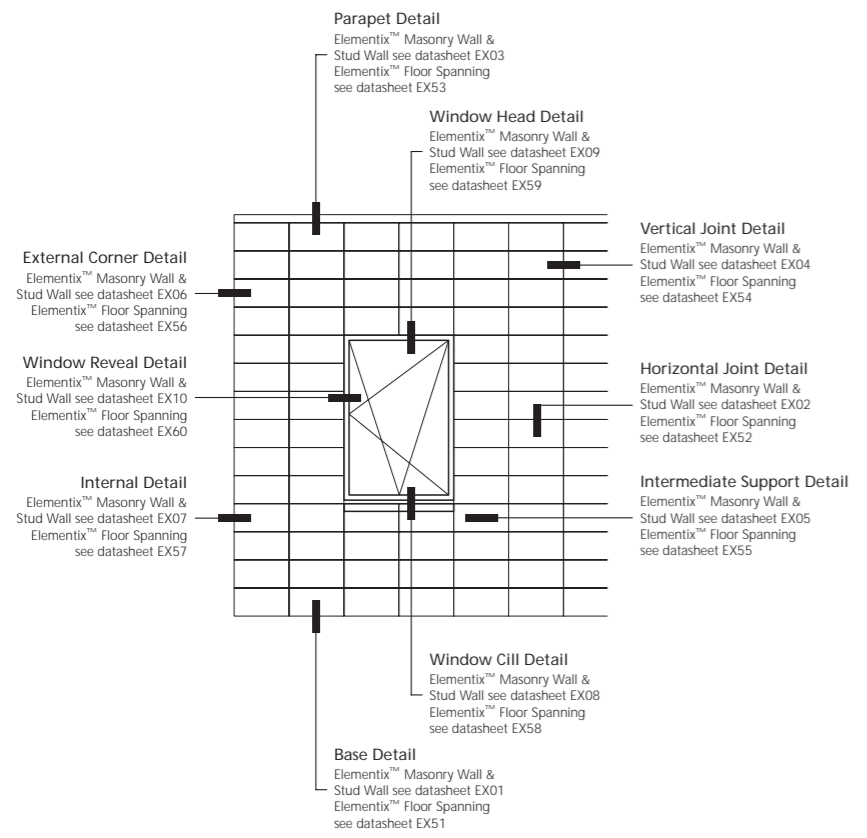

Technical details are available on request and  
are downloadable from **www.ibstock.com**

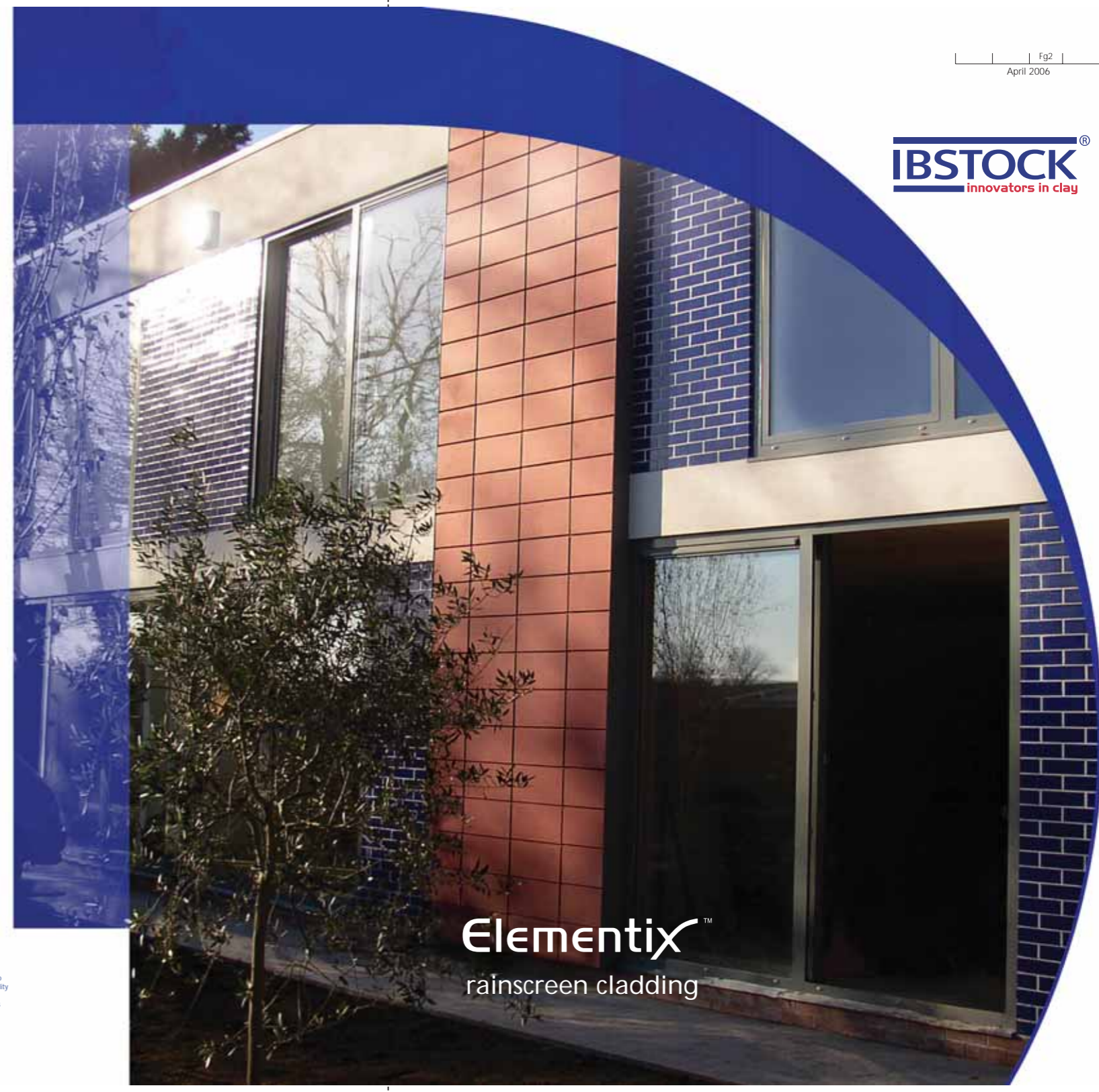

**Elementix**<sup>™</sup>  
rainscreen cladding

# Elementix™

Elementix is a unique rainscreen cladding system that provides specifiers with exciting new glazed finishes and a patented fixing system that allows easier installation.

## Features & Benefits

- Unique colour range of natural clay and real ceramic glazes
- Patented fixing system allows easy installation and replacement of tiles from any point in the façade
- Confidence of backing by UK's largest clay cladding manufacturer with its nationwide network of design advisors to provide expert support
- Colours available to match other glazed products from the Ibstock range
- High strength natural clay tiles ensure a robust cladding with long term durability and low maintenance
- 440mm x 215mm size for ideal co-ordination with standard brickwork and masonry
- Ceram Building Technology endorsed for use right down to ground floor of a building
- Third party tested to CWCT Standard

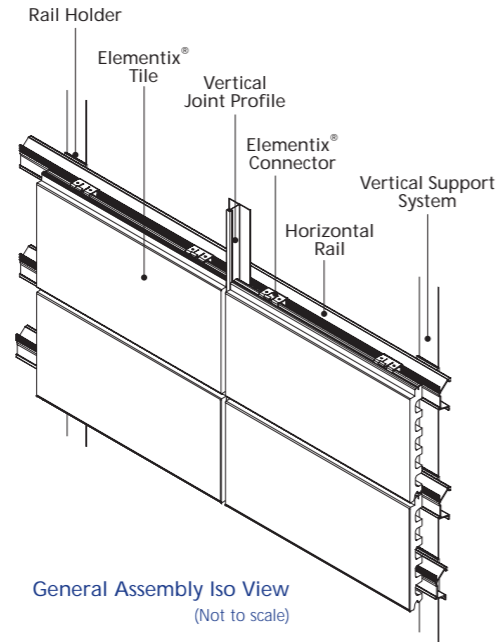

| Elementix® Technical Data:              |                            |
|---|----------------------------|
| Size                                    | 440mm x 215mm              |
| Tile Weight                             | 4.6Kg                      |
| Total System Weight                     | 86Kg/m <sup>2</sup>        |
| Durability                              | Frost Resistant            |
| Transverse Strength (Impact resistance) | 5.8kN Category E to BS8200 |
| Water Absorption                        | < 3%                       |

### Third Party Tests:

CERAM Building Technology.  
Report: SW212.03. Centre for Windows & Cladding Technology – CWCT Standard.

## Colours

Natural Finish | Cream 5201



Natural Finish | Terracotta 5200

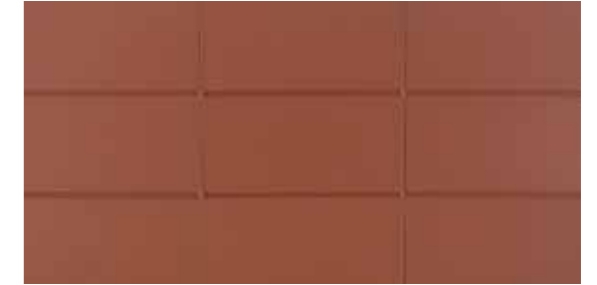

Glazed Finish | Graphite 5205



Glazed Finish | Gold 5206



Glazed Finish | Copper 5203



Glazed Finish | Silver 5202



Glazed Finish | Cobalt 5204

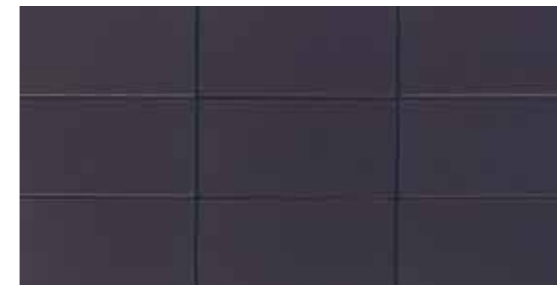

Glazed Finish | Bronze 5207

